

## ELOFIT ACCESSORIES

### EPOXY COATED CONVOLUTED DUCTILE IRON RING ANSI/ASA 150#

**ITEM:** 00FLAVN\_  
**SIZE RANGE:** 2" IPS PE ÷ 30" IPS PE  
**MATERIAL:** Epoxy Coated Ductile Iron  
**COLOR:** Red



#### INSTALLATION INSTRUCTIONS:

It is recommended to use a torque wrench complying with the ISO 6789 series. Care must be taken to ensure that the gasket is centered properly between the two flanges before tightening commences. Bolts shall be tightened crosswise in at least six sequences: 5 % / 20 % / 50 % / 75 % /100 % of final torque. Starting with finger tightness, and consequently by using a torque wrench with the same increment of torque up to the final torque required to achieve the correct tightening pressure in the joint. The torque of the bolts in flange connections is of importance. Therefore, the use of lubricated bolts to minimize external influences is recommended. It is recommended that for diameters above 180 mm, two operators work simultaneously on diametrically opposite bolts if possible. Additional tightening to the recommended torque should be carried out several hours later and on the next day.

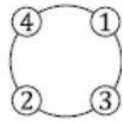

4 Bolts

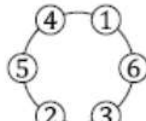

6 Bolts

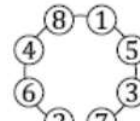

8 Bolts

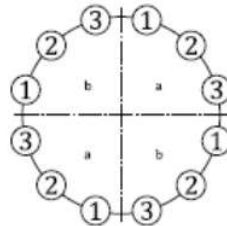



12 Bolts or more

**Key**  
 a First Quadrant.  
 b Second Quadrant.

#### PRODUCT INFORMATION AND APPLICATION USE:

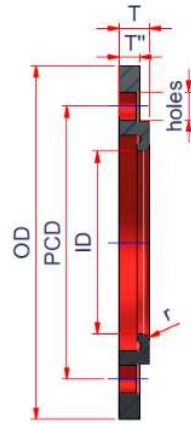
Backing rings are manufactured from a ductile iron inner core and are coated with an epoxy coating. The rings are made to match ANSI/ASME 16.5 dimensions and hole patterns.



CODE	SDR	ANSI 150# HOLE PATTERN	ND (IPS PE)	OD	ID	PCD	T''	T	r	holes	N° holes	
00FLAVN027	7	2"	2"	6	2.46	4.75	0.5	0.75	0.26	0.75	4	335 PSI
00FLAVN037	7	3"	3"	7.5	3.6	6	0.63	0.94	0.26	0.75	4	335 PSI
00FLAVN047	7	4"	4"	9	4.6	7.5	0.63	0.94	0.26	0.75	8	335 PSI
00FLAVN0411	11	4"	4"	9	4.75	7.5	0.38	0.58	0.26	0.75	8	200 PSI
00FLAVN057	7	5"	5"	11	5.69	8.5	0.63	0.94	0.39	0.875	8	
00FLAVN067	7	6"	6"	11	6.75	9.5	0.60	1	0.39	0.875	8	335 PSI
00FLAVN0611	11	6"	6"	11	6.88	9.5	0.38	0.63	0.39	0.875	8	200 PSI
00FLAVN087	7	8"	8"	13.5	8.75	11.75	0.70	1.13	0.39	0.875	8	335 PSI
00FLAVN0811	11	8"	8"	13.5	8.88	11.75	0.50	0.88	0.39	0.875	8	200 PSI
00FLAVN107	7	10"	10"	16	10.92	14.25	0.78	1.19	0.39	1	12	335 PSI
00FLAVN1011	11	10"	10"	16	11	14.25	0.56	1	0.39	1	12	200 PSI
00FLAVN127	7	12"	12"	19	12.92	17	0.90	1.4	0.39	1	12	335 PSI
00FLAVN1211	11	12"	12"	19	13.13	17	0.65	1.25	0.39	1	12	200 PSI
00FLAVN147	7	14"	14"	21	14.18	18.75	1.05	1.63	0.5	1.125	12	335 PSI
00FLAVN1411	11	14"	14"	21	14.38	18.75	0.81	1.38	0.5	1.125	12	200 PSI
00FLAVN167	7	16"	16"	23.5	16.19	21.25	1.10	1.8	0.5	1.125	16	335 PSI
00FLAVN1611	11	16"	16"	23.5	16.38	21.25	0.91	1.67	0.5	1.125	16	200 PSI
00FLAVN187	7	18"	18"	25	18.2	22.75	1.10	1.8	0.5	1.25	16	335 PSI
00FLAVN1811	11	18"	18"	25	18.38	22.75	0.75	1.69	0.5	1.25	16	200 PSI
00FLAVN207	7	20"	20"	27.5	20.38	25	1.20	2.13	0.5	1.25	20	335 PSI
00FLAVN2011	11	20"	20"	27.5	20.38	25	1	1.81	0.5	1.25	20	200 PSI
00FLAVN227	7	22"	22"	29.5	22.38	27.25	1.52	2.3	0.5	1.375	20	
00FLAVN2211	11	22"	22"	29.5	22.38	27.5	1.13	2	0.5	1.375	20	200 PSI
00FLAVN249/11	9/11	24"	24"	32	24.38	29.5	1.13	2.13	0.5	1.375	20	200 PSI
00FLAVN309/11	9/11	30"	30"	38.75	30.38	36	1.30	2.68	0.5	1.375	28	

### MANUFACTURER' S WARRANTY:

Thirty (30) Years from the date of sale upon successful completion of pressure test of the piping system (refer to published warranty for complete details).

### NOTE:

- \* More information can be found on ELOFIT TECHNICAL CATALOGUE
- \*\* Technical Data may undergo dimensional changes, check revision at the top