

CODE	Weight lbs/pc	Volume ft <sup>3</sup> /pc	ND	OD	D	S min	L1	H1	H
12EIG02	0.556	0.0505	2" IPS	2.375	2.68	0.22	2.76	4.72	6.06
12EIG03	0.672	0.1217	3" IPS	3.5	3.8	0.32	3.54	5.85	7.75
12EIG04	2.662	0.1971	4" IPS	4.5	4.8	0.41	3.43	6.3	8.7
12EIG06	6.978	0.5819	6" IPS	6.625	6.77	0.39	4.72	8.94	12.32
12EIG08	18.333	1.2162	8" IPS	8.625	9.17	0.51	5.51	11.02	15.61
12EIG10	30.102	2.1522	10" IPS	10.75	11.34	0.98	6.1	12.8	18.6
12EIG12	46.055	3.4969	12" IPS	12.75	13	1.16	7.6	15.28	21.77

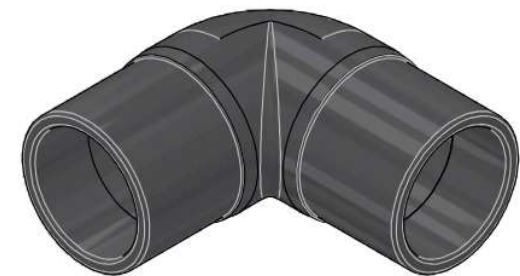

**EloFIT**



AMERICAS

ITEM: **EIG**

DESC: LONG SPIGOT 90° ELBOW  
PE4710 SDR11

C:\Vault\_Temp\Disegn\Schede Tecniche\Elofit inches\Butt Fusion Fittings\EL10060.dwg



DRAWING No:  
**EL10060**

SHEET OF REV.  
**1 1 -6**

www.nupiamericas.com - info@nupiamericas.com

All dimensions have to be considered in inches with 5% tolerance if not otherwise mentioned