

## Butt Tees

Elongated

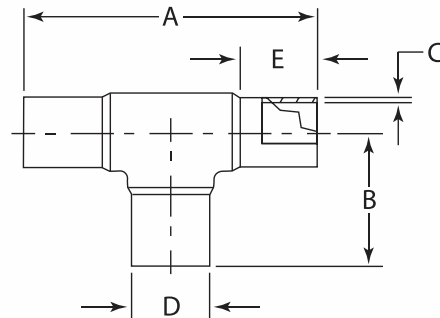

Molded of  
PE100/4710/3408  
Black  
CODE 115

### SDR 17 (Standard Dimension Ratio) 125 PSI (Working Pressure at 73.4 F)

Nominal Diameter (inch)	A (inch)	B (inch)	C (inch)	D (inch)	E (inch)	Weight (lbs.)	Product Code	Box Quantities
2" IPS	8.66	4.33	0.14	2.375	2.48	0.53	115 0002 17	7
3" IPS	11.81	5.91	0.206	3.5	3.54	1.45	115 0003 17	10
4" IPS	13.78	6.89	0.264	4.5	3.94	2.58	115 0004 17	3
6" IPS	18.11	9.06	0.39	6.625	4.72	7.24	115 0006 17	2
8" IPS	23.62	11.81	0.508	8.625	5.71	16.6	115 0008 17	1
10" IPS	27.56	13.78	0.633	10.75	6.3	28.9	115 0010 17	1
12" IPS	31.57	15.97	0.75	12.75	7.52	45.32	115 0012 17	1

### SDR 11 (Standard Dimension Ratio) 200 PSI (Working Pressure at 73.4 F)

Nominal Diameter (inch)	A (inch)	B (inch)	C (inch)	D (inch)	E (inch)	Weight (lbs.)	Product Code	Box Quantities
¾" IPS	5	2.5	0.095	1.05	1.77	0.09	115 0075 11	25
1" IPS	5.67	2.83	0.119	1.315	1.77	0.17	115 0001 11	15
1¼" IPS	6.61	3.31	0.151	1.66	2.01	0.3	115 0125 11	10
1½" IPS	7.99	4	0.173	1.9	2.52	0.47	115 0150 11	15
2" IPS	8.66	4.33	0.216	2.375	2.48	0.82	115 0002 11	7
3" IPS	11.81	5.91	0.318	3.5	3.54	2.18	115 0003 11	10
4" IPS	13.78	6.89	0.409	4.5	3.94	4.02	115 0004 11	3
6" IPS	18.11	9.06	0.603	6.625	4.72	10.91	115 0006 11	2
8" IPS	23.62	11.81	0.785	8.625	5.71	24.61	115 0008 11	1
10" IPS	27.56	13.78	0.978	10.75	6.3	42.6	115 0010 11	1
12" IPS	31.57	15.97	1.16	12.75	7.52	67.85	115 0012 11	1